



Mufă compresie Coupler



Diametru Diameter	Ambalare buc./cutie Packing pcs./box	Cod Code	PN	L1 mm	L mm	H mm
20	25	10KMAN20	16	52,5	119,0	45,0
25	35	10KMAN25	16	54,5	118,5	53,0
32	20	10KMAN32	16	62,5	138,0	64,5
40	12	10KMAN40	16	80,0	167,5	83,5
50	8	10KMAN50	16	90,0	184,0	96,0
63	10	10KMAN63	16	110,0	224,5	113,0
75	14	10KMAN75	10	121,0	246,0	132,0
90	9	10KMAN90	10	144,0	298,0	150,5
110	5	10KMAN110	10	175,5	364,0	177,0

Product Certification
BUREAU VERITAS
Certification

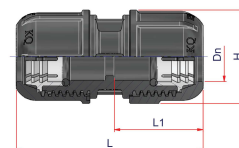

Mufă compresie redusă Reducing coupler



Diametru Diameter	Ambalare buc./cutie Packing pcs./box	Cod Code	PN	L1 mm	L2 mm	L mm	H mm
25-20	20	10KR2520	16	54,5	52,5	111,0	53,0
32-20	15	10KR3220	16	62,5	52,5	128,5	64,5
32-25	12	10KR3225	16	62,5	54,5	129,0	64,5
40-25	8	10KR4025	16	80,0	54,5	145,0	83,5
40-32	8	10KR4032	16	80,0	62,5	145,0	83,5
50-32	6	10KR5032	16	90,0	62,5	163,0	96,0
50-40	4	10KR5040	16	90,0	80,0	160,0	96,0
63-32	2	10KR6332	16	110,0	62,5	187,0	113,0
63-40	2	10KR6340	16	110,0	80,0	204,0	113,0
63-50	12	10KR6350	16	110,0	90,0	228,0	113,0
75-50	3	10KR7550	10	121,0	90,0	228,5	132,0
75-63	14	10KR7563	10	121,0	110,0	233,0	132,0
90-63	2	10KR9063	10	144,0	110,0	254,5	152,0
90-75	2	10KR9075	10	144,0	121,0	290,5	152,0
110-90	6	10KR11090	10	175,5	144,0	330,5	181,0

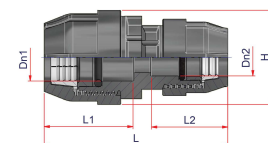

Racord compresie cu flanșă Flange joint



Diametru Diameter	Ambalare buc./cutie Packing pcs./box	Cod Code	PN	L1 mm	L mm	H mm	H1 mm
50x1 1/2"	5	10KRFL50112	16	94	124	149	110
50x2"	5	10KRFL5020	16	94	124	164	125
63x2"	4	10KRFL6320	16	114	137	164	125
75x2 1/2"	6	10KRFL75212	16	137	161	184	146
75x3"	8	10KRFL753	16	144	175	198	158
90x3"	4	10KRFL9030	16	165	197	200	160
90x4"	4	10KRFL9040	16	165	199	220	180
110x4"	2	10KRFL11040	16	185	215	220	180
125x5"	3	10KRFL12550	10	245	270	245	210
125x6"	1	10KRFL12560	10	245	270	245	210
160x5"	2	10KRFL16050	10	280	300	245	210

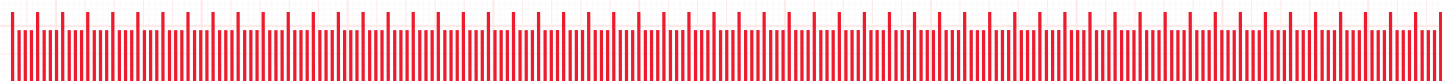
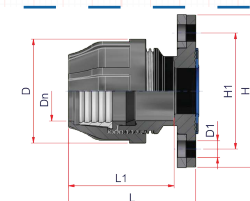



Racord compresie cu filet exterior Male threaded adapter



Product Certification
BUREAU VERITAS
Certification



Diametru Diameter	Ambalare buc./cutie Packing pcs./box	Cod Code	PN	L filet L thread	L1 mm	L mm	H mm
20 x 1/2"	45	10KRFM2012	16	15,0	52,5	80,0	45,0
20 x 3/4"	40	10KRFM2034	16	16,3	52,5	81,0	45,0
25 x 1/2"	35	10KRFM2512	16	15,0	54,5	81,5	53,0
25 x 3/4"	35	10KRFM2534	16	16,3	54,5	83,0	53,0
25 x 1"	30	10KRFM251	16	19,1	54,5	86,0	53,0
32 x 1/2"	15	10KRFM3212	16	15,0	62,5	98,0	64,5
32 x 3/4"	20	10KRFM3234	16	16,3	62,5	99,0	64,5
32 x 1"	35	10KRFM321	16	19,1	62,5	102,0	64,5
32 x 1 1/4"	15	10KRFM32114	16	21,4	62,5	104,5	64,5
40 x 1"	10	10KRFM401	16	19,1	80,0	108,5	83,5
40 x 1 1/4"	18	10KRFM40114	16	21,4	80,0	111,0	83,5
40 x 1 1/2"	10	10KRFM40112	16	21,4	80,0	111,0	83,5
50 x 1 1/4"	6	10KRFM50114	16	21,4	90,0	118,5	96,0
50 x 1 1/2"	12	10KRFM50112	16	21,4	90,0	118,5	96,0
50 x 2"	6	10KRFM502	16	25,7	90,0	123,0	96,0
63 x 1 1/4"	6	10KRFM63114	16	21,4	110,0	141,0	113,0
63 x 1 1/2"	16	10KRFM63112	16	21,4	110,0	141,0	113,0
63 x 2"	16	10KRFM632	16	25,7	110,0	145,0	113,0
63 x 2 1/2"	6	10KRFM63212	16	21,4	110,0	141,0	113,0
75 x 2"	28	10KRFM752	10	25,7	121,0	167,0	132,0
75 x 2 1/2"	20	10KRFM75212	10	30,2	121,0	172,0	132,0
75 x 3"	3	10KRFM753	10	33,0	121,0	175,0	132,0
90 x 2"	2	10KRFM902	10	25,7	144,0	190,0	150,5
90 x 2 1/2"	2	10KRFM90212	10	30,2	144,0	195,0	150,5
90 x 3"	15	10KRFM903	10	33,0	144,0	198,0	150,5
90 x 4"	2	10KRFM904	10	39,0	144,0	203,0	150,5
110 x 2"	3	10KRFM1102	10	25,7	175,5	228,0	177,0
110 x 3"	3	10KRFM1103	10	33,0	175,5	235,0	177,0
110 x 4"	6	10KRFM1104	10	39,0	175,5	242,0	177,0

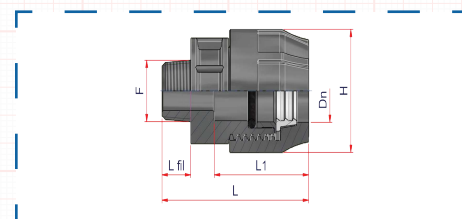

Racord compresie cu filet interior (1/2) Female threaded adapter



Diametru Diameter	Ambalare buc./cutie Packing pcs./box	Cod Code	PN	L filet mm	L1 mm	L mm	H mm
20 x 1/2"	45	10KRFF2012	16	17,3	52,5	77,0	45,0
20 x 3/4"	40	10KRFF2034	16	18,4	52,5	78,5	45,0
25 x 1/2"	35	10KRFF2512	16	17,3	54,5	77,5	53,0
25 x 3/4"	30	10KRFF2534	16	18,4	54,5	78,5	53,0
25 x 1"	30	10KRFF251	16	20,0	54,5	80,0	53,0
32 x 1/2"	20	10KRFF3212	16	17,3	62,5	86,0	64,5
32 x 3/4"	20	10KRFF3234	16	18,4	62,5	87,0	64,5
32 x 1"	35	10KRFF321	16	20,0	62,5	88,0	64,5
32 x 1 1/4"	20	10KRFF32114	16	20,0	62,5	88,5	64,5
40 x 1"	10	10KRFF401	16	20,0	80,0	86,5	83,5
40 x 1 1/4"	20	10KRFF40114	16	22,5	80,0	92,5	83,5
40 x 1 1/2"	10	10KRFF40112	16	22,5	80,0	92,5	83,5
50 x 1 1/4"	6	10KRFF50114	16	22,5	90,0	113,5	96,0
50 x 1 1/2"	12	10KRFF50112	16	22,5	90,0	113,5	96,0
50 x 2"	12	10KRFF502	16	22,5	90,0	113,5	96,0
63 x 1 1/2"	6	10KRFF63112	16	22,5	110,0	137,0	113,0

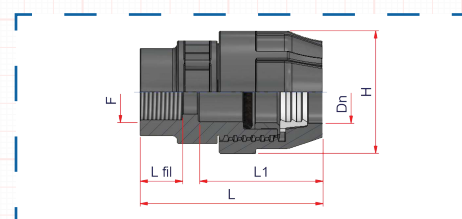



Product Certification
BUREAU VERITAS
 Certification



Racord compresie cu filet interior (2/2)

Female adaptor



Diametru Diameter	Ambalare buc./cutie Packing pcs./box	Cod Code	PN	L filet mm	L1 mm	L mm	H mm
63 x 2"	16	10KRFF632	16	22,5	110,0	137,0	113,0
63 x 2 1/2"	6	10KRFF63212	16	27,5	110,0	142,0	113,0
75 x 2"	4	10KRFF752	10	25,0	121,0	159,0	113,0
75 x 2 1/2"	28	10KRFF75212	10	30,0	121,0	164,0	132,0
75 x 3"	3	10KRFF753	10	33,0	121,0	164,0	132,0
90 x 2"	2	10KRFF902	10	25,0	144,0	179,5	132,0
90 x 2 1/2"	2	10KRFF90212	10	30,0	144,0	184,5	150,5
90 x 3"	16	10KRFF903	10	33,0	144,0	184,5	150,5
90 x 4"	2	10KRFF904	10	39,0	144,0	199,0	150,5
110 x 2"	3	10KRFF1102	10	25,0	175,5	217,5	150,5
110 x 3"	3	10KRFF1103	10	33,0	175,5	222,5	177,0
110 x 4"	8	10KRFF1104	10	39,0	175,5	237,0	177,0

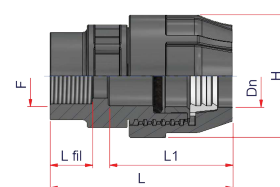

Cot compresie 90°

90° elbow



Diametru Diameter	Ambalare buc./cutie Packing pcs./box	Cod Code	PN	L1 mm	L mm	H1 mm	H mm
20	25	10KG20	16	52,5	93,5	69	93,5
25	20	10KG25	16	54,5	100,0	73	100,0
32	10	10KG32	16	62,5	120,0	86	120,0
40	6	10KG40	16	80,0	152,0	109	152,0
50	4	10KG50	16	90,0	168,0	122	168,0
63	12	10KG63	16	110,0	201,0	147	201,0
75	6	10KG75	10	121,0	236,0	170	236,0
90	4	10KG90	10	144,0	282,0	207	282,0
110	2	10KG110	10	175,5	331,5	243	331,5

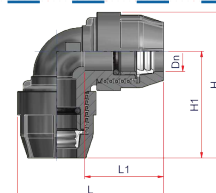

Cot compresie 90° filet exterior (1/2)

90° elbow with threaded male offtake



Diametru Diameter	Ambalare buc./cutie Packing pcs./box	Cod Code	PN	L filet mm	L1 mm	L mm	H mm
20 x 1/2"	35	10KGM2012	16	15,0	52,5	89,0	61,5
20 x 3/4"	35	10KGM2034	16	16,3	52,5	89,0	62,5
25 x 1/2"	25	10KGM2512	16	15,0	54,5	94,5	68,5
25 x 3/4"	25	10KGM2534	16	16,3	54,5	94,5	69,5
25 x 1"	25	10KGM251	16	19,1	54,5	94,5	72,5
32 x 1/2"	15	10KGM3212	16	15,0	62,5	114,0	80,0
32 x 3/4"	14	10KGM3234	16	16,3	62,5	114,0	81,0
32 x 1"	30	10KGM321	16	19,1	62,5	114,0	84,0
32 x 1 1/4"	13	10KGM32114	16	21,4	62,5	114,0	86,0
40 x 1"	8	10KGM401	16	19,1	80,0	128,5	100,5
40 x 1 1/4"	15	10KGM40114	16	21,4	80,0	128,5	103,0
40 x 1 1/2"	7	10KGM40112	16	21,4	80,0	128,5	103,0
50 x 1 1/4"	5	10KGM50114	16	21,4	90,0	150,0	117,5
50 x 1 1/2"	10	10KGM50112	16	21,4	90,0	150,0	117,5
50 x 2"	4	10KGM502	16	25,7	90,0	150,0	121,5
63 1 x 1/2"	6	10KGM63112	16	21,4	110,0	186,0	139,5
63 x 2"	27	10KGM632	16	25,7	110,0	186,0	144,0

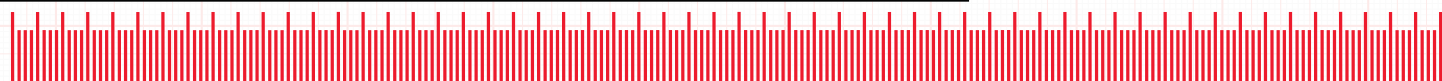
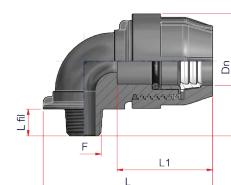



Product Certification
BUREAU VERITAS
Certification



Cot compresiune 90° filet exterior (2/2) 90° elbow with threaded male offtake



Diametru Diameter	Ambalare buc./cutie Packing pcs./box	Cod Code	PN	L filet mm	L1 mm	L mm	H mm
63 x 2 1/2"	2	10KGM63212	16	30,2	110,0	186,0	148,5
75 x 2 1/2"	2	10KGM75212	10	33,0	121,0	228,5	170,5
75 x 3"	2	10KGM753	10	33,0	121,0	228,5	170,5
90 x 3"	2	10KGM903	10	33,0	144,0	260,0	185,0
90 x 4"	2	10KGM904	10	39,0	144,0	260,0	190,0
110 x 4"	3	10KGM1104	10	39,0	175,5	338,0	232,0



Cot compresiune 90° filet interior 90° elbow with threaded female offtake



Diametru Diameter	Ambalare buc./cutie Packing pcs./box	Cod Code	PN	L1 mm	L mm	H mm
20 x 1/2"	35	10KGF2012	16	52,5	84,5	59,5
20 x 3/4"	30	10KGF2034	16	52,5	89,0	59,0
25 x 1/2"	25	10KGF2512	16	54,5	94,5	65,0
25 x 3/4"	25	10KGF2534	16	54,5	91,0	69,0
25 x 1"	25	10KGF251	16	54,5	94,5	66,5
32 x 1/2"	15	10KGF3212	16	62,5	113,5	76,5
32 x 3/4"	15	10KGF3234	16	62,5	113,5	77,5
32 x 1"	30	10KGF321	16	62,5	105,5	79,5
32 x 1 1/4"	13	10KGF32114	16	62,5	113,5	78,5
40 x 1"	15	10KGF401	16	80,0	128,5	95,0
40 x 1 1/4"	15	10KGF40114	16	80,0	128,5	95,0
40 x 1 1/2"	7	10KGF40112	16	80,0	128,5	95,0
50 x 1 1/4"	5	10KGF50114	16	90,0	150,0	109,5
50 x 1 1/2"	10	10KGF50112	16	90,0	150,0	109,5
50 x 2"	4	10KGF502	16	90,0	150,0	112,0
63 x 1 1/2"	6	10KGF63112	16	110,0	186,0	131,5
63 x 2"	11	10KGF632	16	110,0	186,0	134,5
63 x 2 1/2"	2	10KGF63212	16	110,0	186,0	136,0
75 x 2 1/2"	2	10KGF75212	10	121,0	228,5	155,5
75 x 3"	2	10KGF753	10	121,0	230,0	156,0
90 x 3"	2	10KGF903	10	144,0	260,0	170,0
90 x 4"	2	10KGF904	10	144,0	262,0	190,0
110 x 4"	3	10KGF1104	10	175,5	338,0	230,0

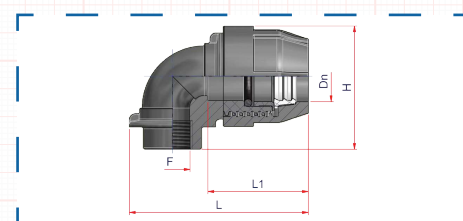

Dop compresiune End cap



Diametru Diameter	Ambalare buc./cutie Packing pcs./box	Cod Code	PN	L1 mm	L mm	H mm
20	50	10KTAPPO20	16	52,5	65,0	45,0
25	35	10KTAPPO25	16	54,5	66,5	53,0
32	20	10KTAPPO32	16	62,5	83,0	54,5
40	12	10KTAPPO40	16	80,0	89,5	83,5
50	6	10KTAPPO50	16	90,0	97,0	96,0
63	16	10KTAPPO63	16	110,0	119,5	113,0
75	4	10KTAPPO75	10	121,0	141,5	132,0
90	16	10KTAPPO90	10	144,0	162,0	150,5
110	10	10KTAPPO110	10	175,5	200,0	177,0

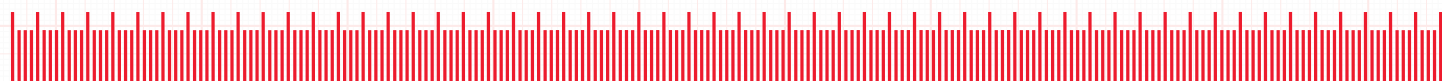
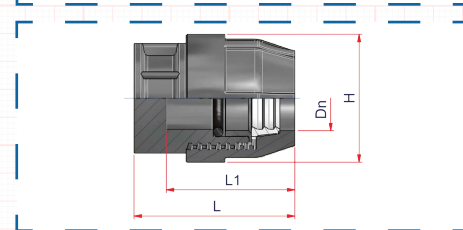

Fitinguri de compresie Compression fittings



Teu compresie redus Reducing tee



Diametru Diameter	Ambalare buc./cutie Packing pcs./box	Cod Code	PN	D1-D3	D2	L1=L3 mm	L2 mm	L4 mm	L mm
25-20-25	20	10KTR252025	16	25	20	54,5	52,5	73	146
32-25-32	13	10KTR322532	16	32	25	62,5	54,5	87	174
40-32-40	6	10KTR403240	16	40	32	80,0	62,5	108	216
50-40-50	4	10KTR504050	16	50	40	95,0	80,0	122	244
63-50-63	2	10KTR635063	16	63	50	110,0	95,0	147	294
75-63-75	3	10KTR756375	10	75	63	121,0	110,0	175	350
90-75-90	4	10KTR907590	10	90	75	144,0	121,0	215	430
110-90-110	1	10KTRR11090110	10	110	90	175,5	144,0	245	490

Product Certification
BUREAU VERITAS
Certification

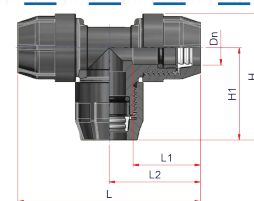
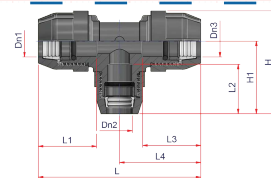

Teu compresie egal 90° 90° equal tee



Diametru Diameter	Ambalare buc./cutie Packing pcs./box	Cod Code	PN	L1 mm	L2 mm	L mm	H1 mm	H mm
20	25	10KT20	16	52,5	68	136	68	91,5
25	20	10KT25	16	54,5	73	146	73	98,0
32	10	10KT32	16	62,5	87	174	87	118,0
40	6	10KT40	16	80,0	108	216	108	152,0
50	4	10KT50	16	95,0	122	244	122	175,0
63	12	10KT63	16	110,0	145	290	145	197,0
75	6	10KT75	10	121,0	168	336	168	234,0
90	4	10KT90	10	144,0	207	414	207	281,5
110	2	10KT110	10	175,5	244	488	244	332,5

Teu compresie 90° filet exterior 90° tee with threaded male offtake



Diametru Diameter	Ambalare buc./cutie Packing pcs./box	Cod Code	PN	L1 mm	L2 mm	L mm	H1 mm	H mm
20 x 1/2"	20	10KTM2012	16	52,5	68	136	39,0	61,5
20 x 3/4"	20	10KTM2034	16	52,5	68	136	40,0	63,0
25 x 1/2"	15	10KTM2512	16	54,5	73	146	42,0	68,5
25 x 3/4"	15	10KTM2534	16	54,5	73	146	43,0	69,5
25 x 1"	15	10KTM251	16	54,5	73	146	46,0	72,5
32 x 1/2"	8	10KTM3212	16	62,5	87	174	48,0	80,0
32 x 3/4"	8	10KTM3234	16	62,5	87	174	49,0	81,0
32 x 1"	15	10KTM321	16	62,5	87	174	52,0	84,0
32 x 1 1/4"	8	10KTM32114	16	62,5	87	174	54,0	86,0
40 x 1"	4	10KTM401	16	80,0	108	216	59,0	100,5
40 x 1 1/4"	4	10KTM40114	16	80,0	108	216	61,0	103,0
40 x 1 1/2"	4	10KTM40112	16	80,0	108	216	61,0	103,0
50 x 1 1/4"	2	10KTM50114	16	95,0	122	244	68,5	116,5
50 x 1 1/2"	5	10KTM50112	16	95,0	122	243	68,5	116,5
50 x 2"	2	10KTM502	16	95,0	122	243	73,0	121,0
63 x 1 1/2"	3	10KTM63112	16	110,0	145	290	85,0	137,0
63 x 2"	3	10KTM632	16	110,0	145	290	90,0	140,0
63 x 2 1/2"	3	10KTM63212	16	110,0	145	290	93,0	145,0
75 x 2 1/2"	4	10KTM75212	10	121,0	175	350	100,0	170,0
75 x 3"	4	10KTM753	10	121,0	175	350	110,0	180,0
90 x 3"	4	10KTM903	10	144,0	215	430	125,0	190,0
90 x 4"	4	10KTM904	10	144,0	215	430	130,0	200,0
110 x 3"	3	10KTM1103	10	175,5	244	488	130,0	210,0
110 x 4"	3	10KTM1104	10	175,5	244	488	150,0	230,0

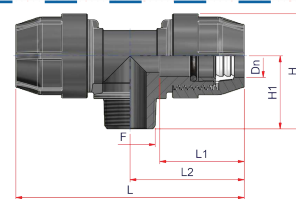



Teu compresiune 90° filet interior 90° tee with threaded female offtake



Product Certification
BUREAU VERITAS
Certification



Diametru Diameter	Ambalare buc./cutie Packing pcs./box	Cod Code	PN	L1 mm	L2 mm	L mm	H1 mm	H mm
20 x 1/2"	20	10KTF2012	16	52,5	68	136	35,5	1,28
20 x 3/4"	20	10KTF2034	16	52,5	68	136	36,5	1,36
25 x 1/2"	15	10KTF2512	16	54,5	73	146	38,5	1,74
25 x 3/4"	30	10KTF2534	16	54,5	73	146	39,0	1,74
25 x 1"	15	10KTF251	16	54,5	73	146	40,0	1,74
32 x 1/2"	8	10KTF3212	16	62,5	87	174	44,5	2,14
32 x 3/4"	8	10KTF3234	16	62,5	87	174	45,5	2,14
32 x 1"	15	10KTF321	16	62,5	87	174	46,5	2,14
32 x 1 1/4"	8	10KTF32114	16	62,5	87	174	46,5	2,56
40 x 1"	9	10KTF401	16	80,0	108	216	53,5	3,80
40 x 1 1/4"	8	10KTF40114	16	80,0	108	216	53,5	3,80
40 x 1 1/2"	4	10KTF40112	16	80,0	108	216	53,5	3,80
50 x 1 1/4"	6	10KTF50114	16	95,0	122	244	60,5	5,12
50 x 1 1/2"	6	10KTF50112	16	95,0	122	243	63,5	5,12
50 x 2"	2	10KTF502	16	95,0	122	243	63,5	5,48
63 x 1 1/2"	3	10KTF63112	16	110,0	145	290	68,0	7,52
63 x 2"	6	10KTF632	16	110,0	145	290	71,0	7,52
63 x 2 1/2"	3	10KTF63212	16	110,0	145	290	74,5	7,52
75 x 2"	4	10KTF752	10	121,0	175	350	100,0	12,38
75 x 2 1/2"	10	10KTF75212	10	121,0	175	350	100,0	12,38
75 x 3"	4	10KTF753	10	144,0	215	430	115,0	12,38
90 x 2 1/2"	5	10KTF90212	10	144,0	215	430	115,0	19,28
90 x 3"	5	10KTF903	10	175,5	244	488	115,0	19,28
110 x 3"	3	10KTF1103	10	175,5	244	488	125,0	26,50
110 x 4"	3	10KTF1104	10	175,5	244	488	125,0	29,18

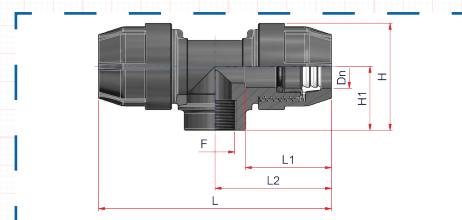

Bridă cu racord de compresiune Clamp saddle with compression fitting



Diametru Diameter	Ambalare buc./cutie Packing pcs./box	Cod Code	PN	L mm	H mm	H1 mm
25-20	150	10KPSXG2520	10	49,0	93,0	52,0
32-20	150	10KPSXG3220	10	49,0	93,0	52,0
40-20	120	10KPSXG4020	10	59,0	101,0	53,5
50-20	100	10KPSXG5020	10	67,5	110,0	53,5
50-25	80	10KPSXG5025	10	67,5	116,0	58,0
63-25	80	10KPSXG6325	10	67,5	138,5	56,0
75-25	70	10KPSXG7525	10	76,0	153,0	58,0
75-32	70	10KPSXG7532	10	76,0	157,0	6,0
90-25	55	10KPSXG9025	10	86,0	159,0	59,0
90-32	50	10KPSXG9032	10	86,0	173,0	64,5
110-25	40	10KPSXG11025	10	99,0	190,5	59,0
110-32	35	10KPSXG11032	10	99,0	193,0	62,5
110-40	30	10KPSXG11040	10	99,0	208,0	76,5
125-25	30	10KPSXG12525	10	99,5	206,0	59,0
125-32	30	10KPSXG12532	10	99,5	209,0	63,5
125-40		10KPSXG12540	10			

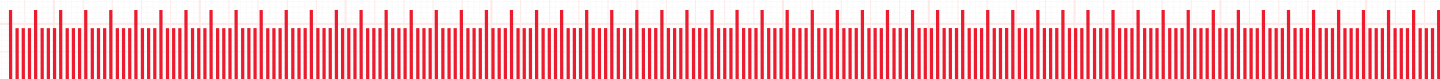
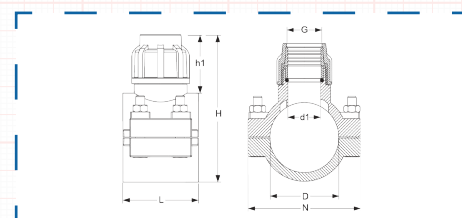



Bridă cu inel de inox (1/2)

Clamp saddle with metal stiffening



Product Certification
BUREAU VERITAS
 Certification



Diametru Diameter	Ambalare buc./cutie Packing pcs./box	Cod Code	PN	L2 mm	H mm	L filet mm
25 x 1/2"	180	10KPSX2512	10	50,0	61,0	19,5
25 x 3/4"	180	10KPSX2534	10	50,0	61,0	19,5
32 x 1/2"	180	10KPSX3212	10	50,0	61,0	19,5
32 x 3/4"	180	10KPSX3234	10	50,0	61,0	19,5
32 x 1"	50	10KPSX3212	10	50,0	61,0	19,5
40 x 1/2"	150	10KPSX4012	10	60,0	70,0	19,5
40 x 3/4"	150	10KPSX4034	10	60,0	70,0	19,5
40 x 1"	30	10KPSX401	10	60,0	70,0	19,5
50 x 1/2"	100	10KPSX5012	10	68,0	81,0	18,0
50 x 3/4"	100	10KPSX5034	10	68,0	81,0	19,0
50 x 1"	100	10KPSX501	10	68,0	81,0	22,0
50 x 1 1/4"	80	10KPSX50114	10	70,0	80,0	21,0
63 x 1/2"	100	10KPSX6312	10	67,5	98,5	17,0
63 x 3/4"	100	10KPSX6334	10	67,5	98,5	17,0
63 x 1"	100	10KPSX631	10	67,5	98,5	17,0
63 x 1 1/4"	100	10KPSX63114	10	67,5	98,5	17,0
63 x 1 1/2"	18	10KPSX63112	10	69,0	99,0	25,0
75 x 1/2"	80	10KPSX7512	10	75,0	113,0	19,5
75 x 3/4"	80	10KPSX7534	10	75,0	113,0	19,5
75 x 1"	80	10KPSX751	10	75,0	113,0	19,5
75 x 1 1/4"	80	10KPSX75114	10	75,0	113,0	19,5
75 x 1 1/2"	80	10KPSX75112	10	75,0	113,0	19,5
75 x 2"	45	10KPSX752	10	79,5	111,0	26,0
90 X 1/2"	60	10KPSX9012	10	84,5	129,0	20,0
90 x3/4"	60	10KPSX9034	10	84,5	129,0	20,0
90 X 1"	60	10KPSX901	10	84,5	129,0	20,0
90 X 1 1/4"	60	10KPSX90114	10	84,5	129,0	20,0
90 X 1 1/2"	60	10KPSX90112	10	84,5	129,0	20,0
90 x 2"	55	10KPSX902	10	84,5	129,0	20,0
110 x 1/2"	40	10KPSX11012	10	99,0	151,0	18,0
110 x 3/4"	40	10KPSX11034	10	99,0	151,0	18,0
110 x 1"	40	10KPSX1101	10	99,0	151,0	18,0
110 x 1 1/4"	40	10KPSX110114	10	99,0	151,0	18,0
110 x 1 1/2"	40	10KPSX110112	10	99,0	151,0	18,0
110 x 2"	40	10KPSX1102	10	99,0	154,0	22,5
110 x 2 1/2"	35	10KPSX110212	10	99,0	154,0	22,5
110 x 3"	25	10KPSX1103	10	99,0	154,0	22,5
125 x 1/2"	35	10KPSX12512	10	111,5	159,0	22,0
125 x 3/4"	35	10KPSX12534	10	99,5	167,0	19,0
125 x 1"	35	10KPSX1251	10	99,5	167,0	19,0
125 x 1 1/4"	35	10KPSX125114	10	99,5	167,0	19,0
125 x 1 1/2"	35	10KPSX125112	10	99,5	167,0	19,0
125 x 2"	35	10KPSX1252	10	99,5	167,0	19,0
125 x 2 1/2"	4	10KPSX125212	10	111,5	165,0	31,5
140 x 1/2"	4	10KPSX14012	10	127,0	178,0	22,0
140 x 3/4"	25	10KPSX14034	10	137,0	188,5	25,0
140 x 1"	25	10KPSX1401	10	137,0	188,5	25,0
140 x 1 1/4"	25	10KPSX140114	10	137,0	188,5	25,0
140 x 1 1/2"	25	10KPSX140112	10	137,0	188,5	25,0
140 x 2"	25	10KPSX1402	10	137,0	188,5	25,0

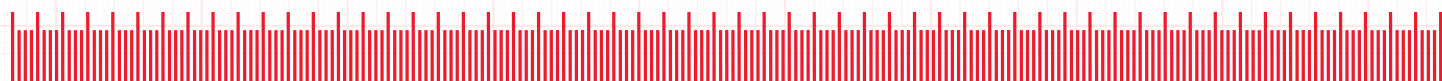
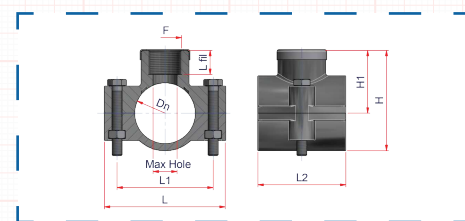



Bridă cu inel de inox (2/2)

Clamp saddle with metal stiffening



Product Certification
BUREAU VERITAS
Certification



Diametru Diameter	Ambalare buc./cutie Packing pcs./box	Cod Code	PN	L2 mm	H mm	Lfillet mm
140 x 2 1/2"	4	10KPSX140212	10	127	185,0	31,5
140 x 3"	15	10KPSX1403	10	137	188,5	25,0
160 x 1/2"	20	10KPSX16012	10	137	213,0	25,0
160 x 3/4"	20	10KPSX16034	10	137	213,0	25,0
160 x 1"	20	10KPSX1601	10	137	213,0	25,0
160 x 1 1/4"	20	10KPSX160114	10	137	213,0	25,0
160 x 1 1/2"	20	10KPSX160112	10	137	209,0	25,5
160 x 2"	15	10KPSX1602	10	137	204,0	25,5
160 x 2 1/2"	8	10KPSX160212	10	127	205,0	31,5
160 x 3"	15	10KPSX1603	10	137	215,5	35,5
160 x 4"	15	10KPSX1604	10	137	210,5	36,5
200 x 3/4"	8	10KPSX2003	10	195	252,0	23,0
200 x 1"	8	10KPSX2001	10	195	252,0	23,0
200 x 1 1/4"	8	10KPSX200114	10	195	247,0	25,0
200 x 1 1/2"	8	10KPSX200112	10	195	243,0	25,5
200 x 2"	8	10KPSX2002	10	195	246,0	25,0
200 x 3"	8	10KPSX2003	10	195	252,0	35,5
200 x 4"	6	10KPSX2004	10	195	255,5	35,5
225x1/2"	6	10KPSX22512	10	195	267,0	25,5
225 x 3/4"	6	10KPSX2253	10	195	267,0	25,5
225 x 1"	6	10KPSX2251	10	195	267,0	25,5
225 x 1 1/4"	6	10KPSX225114	10	195	273,0	25,5
225 x 1 1/2"	6	10KPSX225112	10	195	274,5	25,5
225 x 2"	6	10KPSX2252	10	195	271,0	25,0
225 x 3"	6	10KPSX2253	10	195	279,0	35,5
225 x 4"	4	10KPSX2254	10	195	280,0	35,5
250 x 1"	4	10KPSX2501	10	244	294,5	24,5
250x3/4"	4	10KPSX2503/4	10	244	294,5	24,5
250x1/2"	4	10KPSX2501/2	10	244	294,5	24,5
250 x 1 1/4"	4	10KPSX250114	10	244	295,5	25,5
250 x 1 1/2"	4	10KPSX250112	10	244	296,0	26,0
250 x 2"	4	10KPSX2502	10	244	296,0	26,0
250 x 3"	4	10KPSX2503	10	243	298,0	35,0
250 x 4"	4	10KPSX2504	10	243	298,0	36,0
315 x 1"	3	10KPSX3151	10	244	244,0	23,5
315 x 1 1/4"	3	10KPSX315114	10	244	244,0	26,0
315 x 1 1/2"	3	10KPSX315112	10	244	244,0	26,0
315 x 2"	3	10KPSX3152	10	244	244,0	26,0
315 x 3"	3	10KPSX3153	10	244	244,0	35,0
315 x 4"	3	10KPSX3154	10	244	244,0	35,0

